



## OPERATORS MANUAL

V9



**Warning** to reduce the risk of injury, the user must read and understand the operator's manual

# **IMPORTANT SAFETY INSTRUCTIONS**

## **Save these instructions**

This is not a toy and is intended for proper use by legally-competent mentally fit adults over the age of 21. Vulcan Flamethrowers, LLC and its, managers, members, agents, and representatives shall not be liable for any damages that result from improper or unauthorized use.

### **TO REDUCE RISK OF INJURY:**

- 1 Read all instructions before operating product. Failure to follow all instructions listed below may result in burns, unintentional fires and/or serious injury or death.
2. KEEP OUT OF REACH OF CHILDREN
3. Inspect for leaks before operation. If you notice any leakage discontinue use immediately and contact Vulcan Flamethrowers LLC.
4. Never aim in the direction of anything you don't purposely intend on incinerating.
5. Do not touch the front of the flamethrower (nozzle or pilot torch) they will be hot during and after operation.
6. Do not loosen, unscrew or remove butane canister while a flame is present.
7. Remove butane canister when not in use.
8. Keep all parts of body as far away as possible from nozzle during use.
9. Do not refill fuel tank while pilot flame is ignited.
10. Do not use if there is any wind present.
11. Do not dent, puncture, bend or drop.
13. Do not expose to or use in temperatures higher than 100F or lower than 0F.
14. Fuel has the ability to drip from the nozzle of the device at any time. Always be sure the V9 is pointed safely away from people.
15. Never aim the flamethrower higher than 45 degrees.
16. When the pilot torch is lighted or the nozzle area has flames emitting do not point the nozzle towards your feet; fuel can drip at any time.
17. Turn the pilot torch gas valve to it's fully closed position after use.
18. DO NOT DISASSEMBLE IN ANY WAY.
19. Do not press the button on the handle and run the pump when it's dry for more than 2 seconds or you will permanently damage the pump.
20. Never operate the flamethrower while under the influence of drugs and/or alcohol.

# OPERATION

## 1. Charge the battery fully before use.

- a. The V9 utilizes the M12 LI-ION battery and charger made by Milwaukee.
- b. Insert the battery into the rear of the flamethrower, just below the handle.
  - i. The battery has guide rails, DO NOT FORCE IT IN. (fig A)
- c. To remove the battery gently pinch the sides of the battery and pull.



figA

## 2. Install the butane canister onto the pilot torch.

- a. You can use any camping type butane canister (the smaller the better). These can be purchased at Walmart, Bass Pro Shops, Dick's Sports (usually any where camping equipment is sold).
- b. The canister screws on clockwise and unscrews counterclockwise. (to the left is loose to the right is tight)
- c. Gently line up the threads until the canister is snug against the rubber washer. DO NOT OVER TIGHTEN YOU WILL STRIP THE THREADS. (fig B)

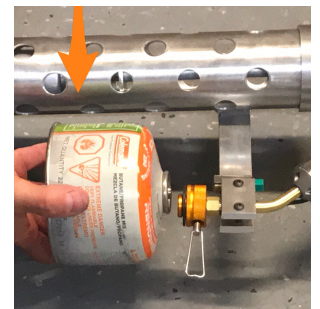

fig B

## 3. Fill the fuel tank.

- a. Unscrew the cap and set aside.
- b. **Do not overfill!** If you do immediately empty some fuel and wipe down the entire V9 with a towel and a cleaner like simple green or another automotive cleaner that will clean up gasoline.
- c. Fill the tank until the fuel is just below the top of the tank. NOT THE TOP OF THE CAP.
- d. Screw the cap on finger tight. (fig C)

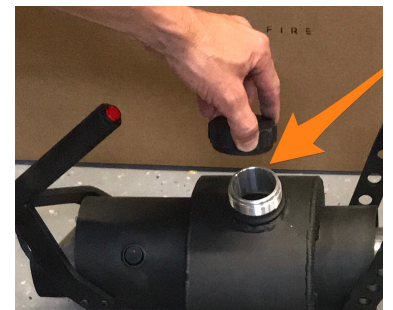

fig C

#### 4. Ready aim fire!

- a. Find an open outdoor area.
- b. Set the flamethrower down on a flat surface.
- c. Turn the gas valve on the pilot torch counter clockwise until you hear gas hiss. **DON'T OPEN FULLY.** (fig D)
- d. Press the igniter several times to create a spark. If the torch doesn't ignite immediately. Turn the gas knob to the closed position and slowly open again. Then press the igniter several times. (fig E)
- e. The pilot torch is sensitive and only a small amount of gas is required to lite. Once lit adjust the knob until you have a positive flame
- f. Press the on button. **Once the flamethrower is turned on if you press the button on the handle it will spray fuel out of the tip.**



Fig D

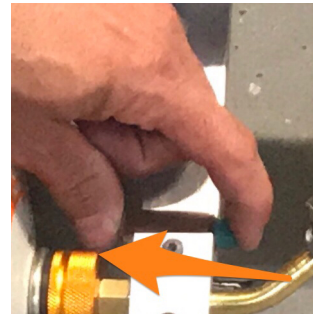

fig E

#### 5. When your finished being awesome.

- a. Turn the pilot torch off and remove the butane canister.
- b. Press the off button and remove the battery.
- c. When you stop using the flamethrower there still may be residual fuel in the last few inches of the line. Always place a towel under the tip to catch any fuel drips

Thank you for your purchase, have fun and be safe.

Vulcan Flamethrowers LLC.